

CS2000 Technical Specification

CS2000 Installation Instructions Of Optional Outside Panel or Switch Panel

An optional outside panel (CS102 or CS103) may be used with the CS2000. The outside panel, as its name implies, is mounted outside the room to give an indication of the status of the LEDs for that particular room.

If you are installing a system where outside monitor panels are used, an electrician must run the short cable (40 feet) supplied, and install an electrical back box (supplied by Varitronics) in the wall. After the wiring has been done, the cable must be plugged into the CS2000 unit and the outside panel. The procedure is as follows:

- 1. Unplug the CS2000 unit from the wall outlet.
- 2. Remove the rear access cover by removing the two slotted head screws.
- 3. Plug the 6 conductor cable into J3 on the printed circuit card inside the CS2000 unit. J3 is located next to the transformer, on the upper left side of the board. Note that the connector can only be plugged in one way.
- 4. Replace the rear access cover, routing the cable through one of the slots in the access cover. Replace the slotted head screws.

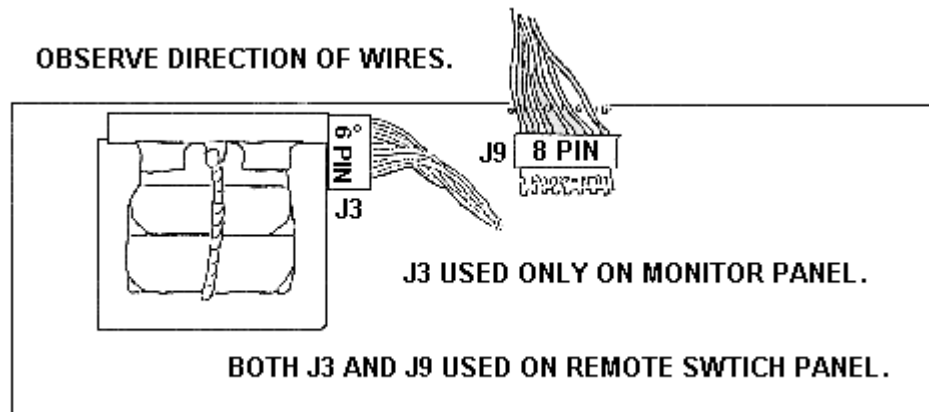

CS2000 Technical Specification

CS2000 Installation Instructions Of Optional Outside Panel Or Switch Panel

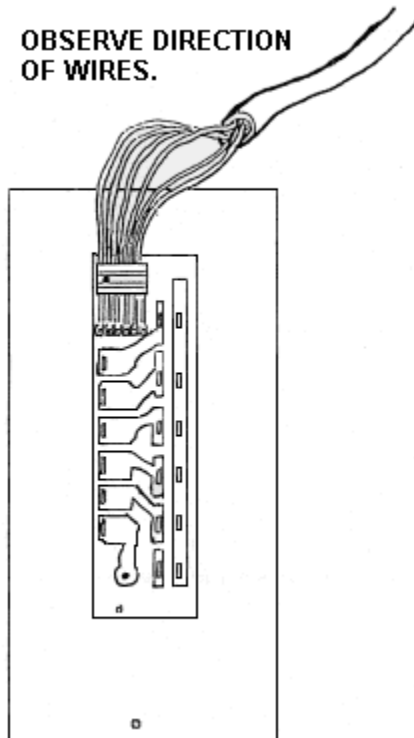

- 5. Plug the connector into the outside panel. Screw the outside panel into the back box.
- 6. Plug the CS2000 unit back into the wall outlet. Using the **COLOR** keys, whose operation is explained in the *CS2000 User's Manual*, check the outside panel. Assure that the appropriate lights on the outside panel are illuminated with those on the corresponding CS2000 unit.

CS2000 Technical Specification

CS2000 Installation Instructions Of Optional Outside Panel or Switch Panel

MOUNTING INSTRUCTIONS FOR CS102 & CS103

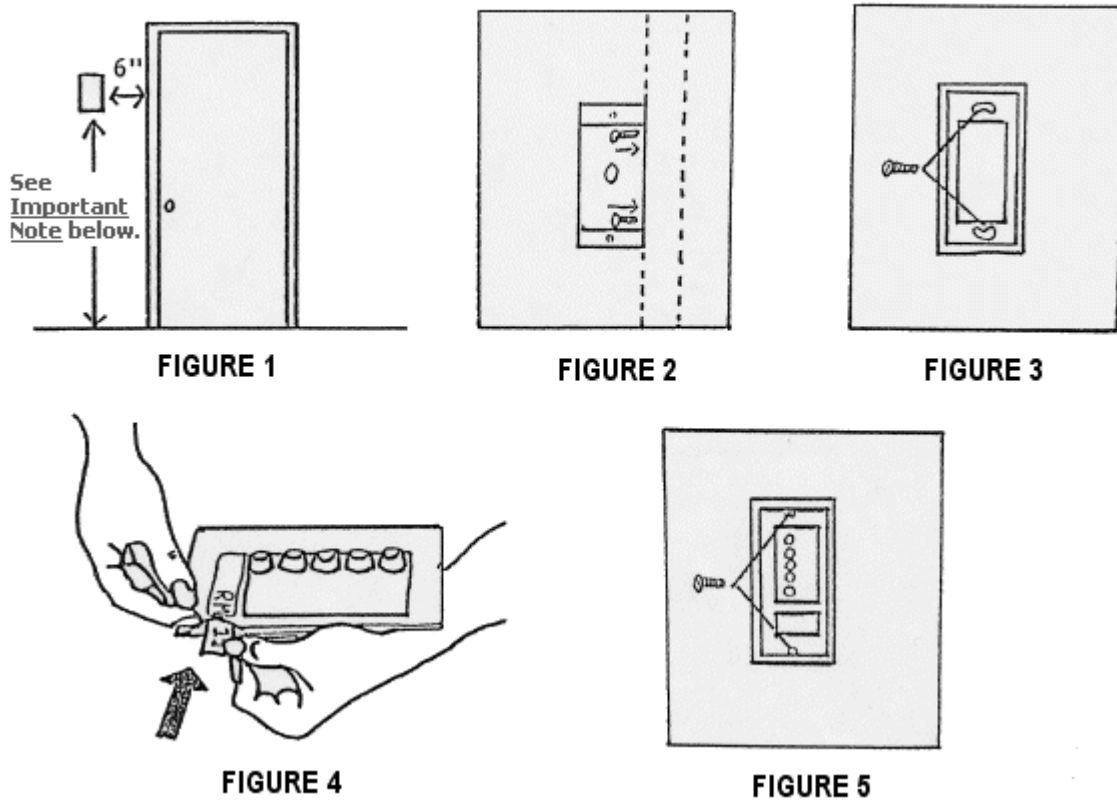

- **FIGURE 1** - Mount back box supplied by Varitronics, long dimensions up and down. When mounting outside the door, the edge of the box should be a minimum of 6" from the side of the door frame molding.

IMPORTANT NOTE: Please refer to local ADA regulations for proper back box mounting height of all room panels.

For ergonomic height, we recommend mounting the outside room back box 58 inches from the bottom of the floor. **However, this does not meet ADA regulations.**

- **FIGURE 2** - Secure back box to stud.
- **FIGURE 3** - After wall papering or painting mount bezel to back box.
- **FIGURE 4** - Carefully lift edge of overlay in window area and slip the proper room identification tag into slot.
- **FIGURE 5** - After appropriate wiring is done, use the black miniature Phillips head screws supplied to attach plate to bezel. Use only the black screws provided.

NOTE: If back box is not required, mount bezel to wall using the two curved holes in the bezel, and cut wall to fit opening in bezel.